

## Supplier Verification for Toys

As a supplier of toys you must complete this form and return it to us along with test reports and photos as required to verify the products supplied meet the requirements of Australia's and New Zealand's applicable mandatory safety standards and bans for toys. These products will not be accepted by us or offered for sale until you have provided this verification.

It is illegal to supply toys in Australia or New Zealand if they do not comply with applicable mandatory safety standards and bans.

By completing this form you verify that products identified in this form comply with all the applicable mandatory standards and bans for toys.

Some of the mandatory safety standards that apply to toys include:

- **Small parts in toys (up to 3 years)** – Australia: Consumer Protection Notice No. 14 of 2003 as amended by Consumer Protection No. 1 of 2005; New Zealand: Product Safety Standards (Children's Toys) Regulations 2005 – **refer Annexure A**
- **Migration of elements (up to 6 years)** – Australia: Consumer Protection Notice No. 1 of 2009; New Zealand: Unsafe Goods (Lead in Children's Toys) Notice 2009 – **refer Annexure B**
- **Projectile toys (up to 14 years)** – Australia: *Consumer Goods (Projectile Toys) Safety Standard 2020* – **refer Annexure C**
- **Aquatic toys (up to 14 years)** – Australia: *Consumer Goods (Aquatic Toys) Safety Standard 2020* – **refer Annexure D**
- **Toys containing hazardous magnets (up to 14 years)** – Australia: *Consumer Goods (Toys Containing Magnets) Safety Standard 2020* – **refer Annexure E**

Some of the bans that apply to toys include:

- **Plastic with more than 1% DEHP (up to 3 years)** – Australia: Consumer Protection Notice No. 11 of 2011 – **refer Annexure A**
- **Small high powered magnets** – Australia: Consumer Protection Notice No. 5 of 2012; New Zealand: Unsafe Goods (Small High Powered Magnets) Indefinite Prohibition Notice 2014 – **refer Annexure F**.

## Supplier Verification for Toys

<b>Supplier:</b>	Company:		
	Address:		
	Telephone:	Email:	
<b>Product:</b>	Identify all products covered by this form:		
<b>Authority:</b>	Name:	Sign:	Date:     /     /

Supplier Verification	Tick if Complies
<b>Complies with Mandatory Standards</b> – Confirmation the product complies with all applicable Mandatory Standards	
<ul style="list-style-type: none"> <li><b>Mandatory Standard for Toys for Children up to 3 years (small parts and DEHP)</b></li> </ul>	<input type="checkbox"/> YES (Complete Annex A) <input type="checkbox"/> NOT APPLY
<ul style="list-style-type: none"> <li><b>Mandatory Standard for Migration of Elements in Toys (up to 6 years)</b></li> </ul>	<input type="checkbox"/> YES (Complete Annex B) <input type="checkbox"/> NOT APPLY
<ul style="list-style-type: none"> <li><b>Mandatory Standard for Projectile Toys (up to 14 years)</b></li> </ul>	<input type="checkbox"/> YES (Complete Annex C) <input type="checkbox"/> NOT APPLY
<ul style="list-style-type: none"> <li><b>Mandatory Standard for Aquatic Toys (up to 14 years)</b></li> </ul>	<input type="checkbox"/> YES (Complete Annex D) <input type="checkbox"/> NOT APPLY
<ul style="list-style-type: none"> <li><b>Mandatory Standard for Toys Containing Hazardous Magnets (up to 14 years)</b></li> </ul>	<input type="checkbox"/> YES (Complete Annex E) <input type="checkbox"/> NOT APPLY

## Annexure A - Toys for Children Up to 3 years

**As a supplier of “toys for children up to 3 years” you must complete this Annexure to verify the products to be supplied meet the requirements of Australia’s and New Zealand’s mandatory standard for toys for children up to 3 years.**

By completing this Annexure you are verifying the products comply with the mandatory standard for toys for children up to 3 years.

**What products must comply? Toys for children up to and including 36 months old being objects manufactured, designed, labelled or marketed as playthings.** Some examples include: rattles, toy dummies, teethingers; squeeze toys; toys to be attached to a crib, stroller, playpen or baby carriage; pull and push toys; pounding toys; blocks; stacking toys; toys for use in a bath tub; rocking, spring and stick horses and figures; musical chime toys; jacks-in-the-box; stuffed, plush and flocked animals and figures; toys with pompoms games; puzzles; dolls; toy cars, trucks and other vehicles.

**NOTE:** Even if toys are labelled and/or marketed for older children, the mandatory standard may apply if the toys are commonly recognised as being intended or suitable for children under 36 months of age. Some guidance on appropriate ages for using toys can be found in: Annex B of AS/NZS ISO 8124.1:2002 Safety of toys; and United States age determination guidelines by the US Consumer Product Safety Commission.

Supplier Verification – Please complete all the following	Tick if Complies
<b>Complies with Mandatory Standard</b> – Confirm the product to be supplied complies with the Australian and new Zealand Mandatory Standard for toys for children up to 3 years.	<input type="checkbox"/> YES
<b>Test Report</b> – Test report provided that meets the following requirements:	<input type="checkbox"/> YES (test report attached)
<ul style="list-style-type: none"> <li>confirms the product meets all the applicable requirements of the <b>Australian / New Zealand Standard for safety of toys</b> (AS/NZS 8124.1:2002 <i>Safety of toys, Part 1: Safety aspects related to mechanical and physical properties</i>) or the equivalent requirements of one of the following standards:                             <ul style="list-style-type: none"> <li><b>Australian / New Zealand Standard for safety of toys</b> (AS/NZS ISO 8124.1:2019 <i>Safety of toys, Part 1: Safety aspects related to mechanical and physical properties</i>); <b>or</b></li> <li><b>European Standard for safety of toys</b> (EN 71-1:2014 + A1:2018 <i>Safety of toys – Part 1: Mechanical and physical properties</i>); <b>or</b></li> <li><b>US Standard for toy safety</b> (ASTM F963-17 <i>Standard consumer safety specification for toy safety</i>)</li> </ul> </li> </ul>	<input type="checkbox"/> YES
<ul style="list-style-type: none"> <li>if there is any soft or foamed plastic in the product - confirms the product does not contain more than 1% (DEHP), which is a chemical identified by the unique Chemical Abstract Service (CAS) Number 117-81-7 also known as: diethylhexyl phthalate or di(2-ethylhexyl)phthalate and bis(2-ethylhexyl) phthalate.</li> </ul>	<input type="checkbox"/> YES  <input type="checkbox"/> NO SOFT PLASTIC
<ul style="list-style-type: none"> <li>provided by an independent testing facility that has accreditation for one of the above standards</li> </ul>	<input type="checkbox"/> YES
<ul style="list-style-type: none"> <li>clearly and accurately identifies the exact product to be supplied</li> </ul>	<input type="checkbox"/> YES

## Annexure B - Toys for Children up to 6 years – Migration of Elements

As a supplier of “toys for children up to 6 years” you must complete this Annexure to verify the products to be supplied meet the requirements of Australia’s and New Zealand’s mandatory standard for migration of elements in toys for children up to 6 years.

By completing this Annexure you are verifying the products comply with the mandatory standard for migration of elements.

**What products must comply?** Toys for children up to 6 years old that are designed or clearly intended for use in play by children.

**What products do not have to comply?** Sporting goods, camping goods, bicycles, home and public playground equipment, trampolines, electronic game units, models powered by combustion or steam engines and fashion jewellery for children.

Supplier Verification – Please complete all the following	Tick if Complies																		
<b>Complies with Mandatory Standard</b> – Confirm the product to be supplied complies with the Australian and New Zealand Mandatory Standard for migration of elements for children up to 6 years.	<input type="checkbox"/> YES																		
<b>Test Report</b> – Test report provided that meets the following requirements:	<input type="checkbox"/> YES (test report attached)																		
<ul style="list-style-type: none"> <li>confirms the product meets all the applicable requirements of the <b>Australian / New Zealand Standard for migration of elements</b> (AS/NZS 8124.3:2012 ‘Safety of toys, Part 3 - Migration of certain elements’) or the equivalent requirements of one of the following standards: <ul style="list-style-type: none"> <li><b>US Standard for safety of toys</b> (ASTM F963-17 Standard consumer safety specification for toy safety); or</li> <li><b>European Standard for migration of elements</b> (EN 71-3:2019 Safety of toys – Part 3: Migration of certain elements)</li> </ul> </li> </ul>	<input type="checkbox"/> YES																		
<ul style="list-style-type: none"> <li>confirms the toy contains less than the following maximum acceptable levels of migratable lead and other elements: <table border="1"> <thead> <tr> <th>Element</th> <th>Antimony</th> <th>Arsenic</th> <th>Barium</th> <th>Cadmium</th> <th>Chromium</th> <th>Lead</th> <th>Mercury</th> <th>Selenium</th> </tr> </thead> <tbody> <tr> <td><b>Max Quantity (mg/kg)</b></td> <td>60</td> <td>25</td> <td>1000</td> <td>75</td> <td>60</td> <td>90</td> <td>60</td> <td>500</td> </tr> </tbody> </table> </li> </ul>	Element	Antimony	Arsenic	Barium	Cadmium	Chromium	Lead	Mercury	Selenium	<b>Max Quantity (mg/kg)</b>	60	25	1000	75	60	90	60	500	<input type="checkbox"/> YES
Element	Antimony	Arsenic	Barium	Cadmium	Chromium	Lead	Mercury	Selenium											
<b>Max Quantity (mg/kg)</b>	60	25	1000	75	60	90	60	500											
<ul style="list-style-type: none"> <li>provided by an independent testing facility that has accreditation for one of the above standards</li> </ul>	<input type="checkbox"/> YES																		
<ul style="list-style-type: none"> <li>clearly and accurately identifies the exact product to be supplied</li> </ul>	<input type="checkbox"/> YES																		

## Annexure C – Projectile Toys for Children Up to 14 years

**As a supplier of “projectile toys for children up to 14 years” you must complete this Annexure to verify the products to be supplied meet the requirements of Australia’s mandatory standard for projectile toys.**

By completing this Annexure you are verifying the products comply with the mandatory standard for projectile toys.

**What products must comply?** Toys designed or clearly intended for use in play by children up to 14 years capable of launching a projectile.

Supplier Verification – Please complete all the following	Tick if Complies
<b>Complies with Mandatory Standard</b> – Confirm the product to be supplied complies with the Australian Mandatory Standard for projectile toys for children up to 14 years.	<input type="checkbox"/> YES
<b>Test Report</b> – Test report provided that meets the following requirements:	<input type="checkbox"/> YES <b>(test report attached)</b>
<ul style="list-style-type: none"> <li>• confirms the product meets the following requirements of one of the following standards:                             <ul style="list-style-type: none"> <li>○ clauses 4.18 and 4.19 of the <b>Australian / New Zealand Standard for safety of toys</b> (AS/NZS ISO 8124.1:2019 <i>Safety of toys, Part 1: Safety aspects related to mechanical and physical properties</i>); <b>or</b></li> <li>○ clauses 4.18 and 4.19 of the <b>International Standard for safety of toys</b> (ISO 8124-1:2018 <i>Safety of toys—Part 1: Safety aspects related to mechanical and physical properties</i>); <b>or</b></li> <li>○ clauses 4.11(e) and 4.17 of the <b>European Standard for safety of toys</b> (EN 71-1:2014 + A1:2018 <i>Safety of toys – Part 1: Mechanical and physical properties</i>); <b>or</b></li> <li>○ clause 4.21 of the <b>US Standard for toy safety</b> (ASTM F963-17 <i>Standard consumer safety specification for toy safety</i>)</li> </ul> </li> </ul>	<input type="checkbox"/> YES
<ul style="list-style-type: none"> <li>• provided by an independent testing facility that has accreditation for one of the above standards</li> </ul>	<input type="checkbox"/> YES
<ul style="list-style-type: none"> <li>• clearly and accurately identifies the exact product to be supplied</li> </ul>	<input type="checkbox"/> YES
<b>Warning</b> - There is a warning on the packaging and instructions accompanying the toy to the effect: <b>WARNING: Do not aim at eyes or face.</b> NOTE: This warning is only required if the toy satisfies all the following: <ul style="list-style-type: none"> <li>• it might reasonably be possible to aim the projectile toy at the eyes or face; and</li> <li>• the projectile toy is capable of launching a projectile more than 300 millimetres; and</li> <li>• the projectile toy is capable of launching a projectile with a kinetic energy greater than 0,08 J.</li> </ul>	<input type="checkbox"/> YES  <input type="checkbox"/> NOT REQUIRED

## Annexure D – Aquatic Toys for Children Up to 14 years

**As a supplier of “aquatic toys for children up to 14 years” you must complete this Annexure to verify the products to be supplied meet the requirements of Australia’s mandatory standard for aquatic toys.**

By completing this Annexure you are verifying the products comply with the mandatory standard for aquatic toys.

**What products must comply?** A toy designed to bear the mass of a child under the age of 14 for use in play in shallow water (whether or not it is inflatable and whether or not it is designed to be worn or otherwise attached to the body).

**INCLUDING** but not limited to:

- inflatable novelty shapes;
- inflatable toy boats intended for use in shallow water;
- unattached complete or partial rings.

**NOT including:**

- beach balls, surfboards, body boards or kick boards;
- inflatable boats intended for use in deep water;
- inflatable air beds.

Supplier Verification – Please complete all the following	Tick if Complies
<b>Complies with Mandatory Standard</b> – Confirm the product to be supplied complies with the Australian Mandatory Standard for projectile toys for children up to 14 years.	<input type="checkbox"/> YES
<b>Warning on toy</b> – One of the following warnings appears on the toy: <ul style="list-style-type: none"> <li>• <b>Option A: - WARNING AQUATIC TOY USE ONLY UNDER SUPERVISION</b> The above warning is in BLOCK CAPITALS no less than 6mm high and in a colour contrasting with background.</li> <li>• <b>Option B:- This is not a life saving device. The toy should only be used in shallow water and under supervision.</b> The above warning is in English, clearly legible, clearly visible and indelible.</li> </ul>	<input type="checkbox"/> Option A (only allowed until 11 June 2022)  <input type="checkbox"/> Option B
<b>Valves</b> – A visual inspection of the product has been conducted that confirms there are <b>non-return valves</b> with <b>stoppers permanently attached</b> to the toy and the stopper is be capable of being pushed into the toy so that it does <b>not stand more than 5 mm from the surface</b> of the toy when the toy is inflated.	<input type="checkbox"/> YES

## Annexure E – Toys Containing Hazardous Magnets

**As a supplier of “toys containing magnets” you must complete this Annexure and return it to us to verify the products to be supplied meet the requirements of Australia’s mandatory standard for toys containing hazardous magnets.**

By completing this Annexure you are verifying the products comply with the mandatory standard for toys containing hazardous magnets.

**What products must comply?** All toys for children under 14 years that contain a “**hazardous magnet**” which is a magnet with a magnetic strength or flux index more than 50 kG<sup>2</sup> mm<sup>2</sup> and comes in any of the following shapes and sizes or fits within any of the following:

- a cylinder with a length of 32 mm or less and a diameter of 11 mm or less;
- a disc with a diameter of 26 mm or less and a thickness of 5 mm or less;
- a sphere with a diameter of 22 mm or less.

**What products do not have to comply?** Sporting goods, camping goods, bicycles, home and public playground equipment, trampolines, electronic game units, models powered by combustion or steam engines, and fashion jewellery.

Supplier Verification – Please complete all the following	Tick if Complies
<b>Complies with Mandatory Standard</b> – Confirm the product to be supplied complies with the Australian Mandatory Standard for toys containing magnets.	<input type="checkbox"/> YES
<b>Test Report</b> – Test report provided that meets the following requirements:	<input type="checkbox"/> YES (test report attached)
<ul style="list-style-type: none"> <li>• confirms the product meets the requirements of one of the following standards as modified by the Mandatory Standard:                             <ul style="list-style-type: none"> <li>○ <b>Australian / New Zealand Standard</b> – AS/NZS ISO 8124.1:2019 Safety of toys, Part 1 (clauses 4.1 and 4.31);</li> <li>○ <b>European Standard</b> – EN 71-1:2014 + A1:2018 Safety of toys – Part 1 (clause 4.23);</li> <li>○ <b>International Standard</b> – ISO 8124-1:2018 Safety of toys – Part 1 (clauses 4.1 and 4.31); or</li> <li>○ <b>US Standard</b> – ASTM F963-17 Standard consumer safety specification for toy safety (clauses 4.38, 8.5 and 8.9).</li> </ul> </li> </ul>	<input type="checkbox"/> YES
<ul style="list-style-type: none"> <li>• provided by an independent testing facility that has accreditation for one of the above standards</li> </ul>	<input type="checkbox"/> YES
<ul style="list-style-type: none"> <li>• clearly and accurately identifies the exact product to be supplied</li> </ul>	<input type="checkbox"/> YES
<b>Warning label for experimental sets for children 8 years and over</b> – The <b>packaging AND instructions</b> includes a statement similar to the following: <b>Warning. Not suitable for children under 8 years. The product contains (a) small magnet(s). Swallowed magnets can stick together across intestines causing serious injuries. Seek immediate medical attention if magnet(s) are swallowed.</b>	<input type="checkbox"/> YES  <input type="checkbox"/> NOT APPLY

## Annexure F – Small High Powered Magnets

As a supplier of “magnets” you must complete this Annexure and return it to us to verify the products to be supplied meet the requirements of Australia’s and New Zealand’s permanent ban on small, high powered magnets.

By completing this Annexure you are verifying the products are not small, high powered magnets.

**What products are banned? Small high powered magnets”** are banned are must not be supplied.

**What are “Small high powered magnets”?** Separable or loose magnetic objects that are supplied in **multiples of two or more** for personal, domestic or household use where:

- (a) at least two of those magnetic objects are each separately able to fit entirely, in any orientation, into the small parts cylinder (see below);
- (b) at least two of those magnetic objects each separately have a magnetic flux index greater than 50 (kG)2 mm2 ; and
- (c) the magnetic objects are marketed by the supplier as, or supplied for use as:
  - a toy, game or puzzle (including an adult desk toy, an educational toy or game, a toy, game or puzzle for mental stimulation or stress relief); or
  - a construction or modelling kit; or
  - jewellery to be worn in or around the mouth or nose.

Supplier Verification – Please complete all the following	Tick if Complies
<b>Complies with Ban</b> – Confirmation that all magnets to be supplied are <b>not</b> “small high powered magnets” and comply with the Australia’s and New Zealand’s permanent ban on small, high powered magnets.	<input type="checkbox"/> YES

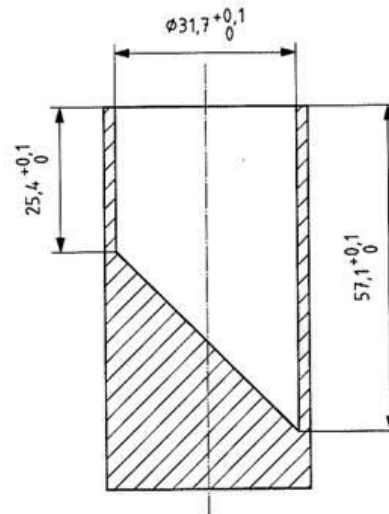

Small parts cylinder (dimensions in millimetres)