

# SELECTIONS MOTOR KIT

## INSTRUCTIONS

### Instruction Of Buttons

Note: If you need to replace the battery, push the back cover down.

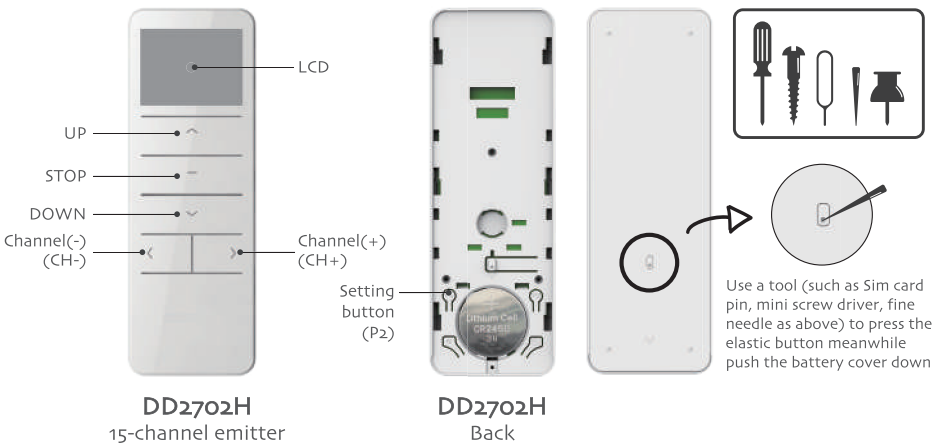

### Technical specification

Battery: 3V (CR2450)	Battery life: >2 years	Radio frequency: 433.05~434.79MHz
Working temperature: -10°C~50°C	Transmitting power: 10 mW	Radio range: 200 meters outdoor, 35 meters indoor

### Warning

- 1, Emitter couldn't expose to moisture or be striked heavily, or else the emitter life will be affected.
- 2, If the emitter is not so sensitive or the radio range becomes shorter, pls check whether to change the battery.
- 3, If the voltage is less than 2.6V, there will be a low voltage indication.
- 4, Under uni-directional mode, if you press any button more than 20S, while under bi-directional mode, you press any button 5S, the emitter will stop sending radio signals.
- 5, It's forbidden to use different type battery to avoid any dangerous risk.
- 6, Dispose of used batteries properly.



### WARNING

#### THIS PRODUCT CONTAINS A BUTTON BATTERY

If swallowed, a lithium button battery can cause severe or fatal injuries within 2 hours.  
Keep batteries out of reach of children.  
If you think batteries may have been swallowed or placed inside any part of the body, seek immediate medical attention.



## Max. Channels Adjustment

Note: 1, In the setting status, press UP or DOWN button to exit quickly.  
2, Repeat the same process if you want to adjust the Max. channels.

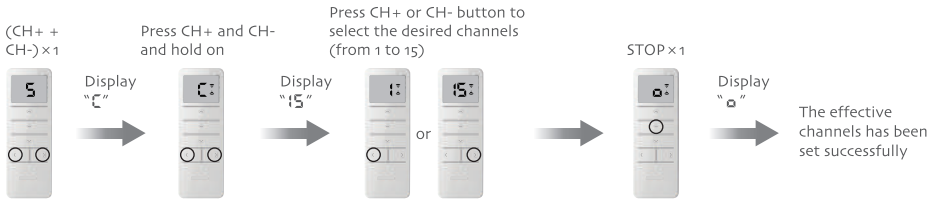

## Uni-directional / Bi-directional Mode Switch

Note: The factory default mode is Bi-directional mode, repeat the same operation to switch the mode circularly.

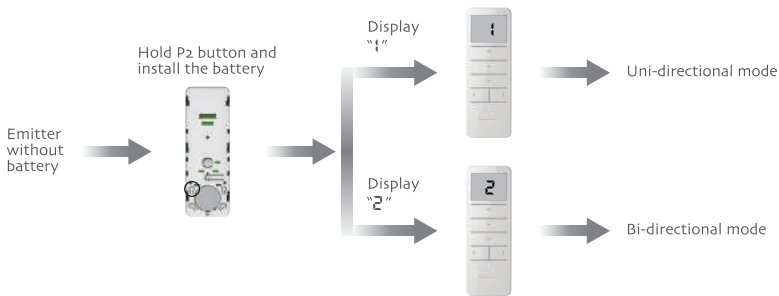

## Combination Button Lock / Unlock Operation

Note: 1, If there is no operation for 10 seconds, it will automatically exit the setting status. 2, The factory default is unlock status, repeat same operation to switch status circularly. 3, Under lock status, the combination buttons don't work; Under unlock status, the combination buttons will work normally. 4, Only the transmitting code will be affected if the combination buttons are locked.

Press and hold STOP button more than 15s

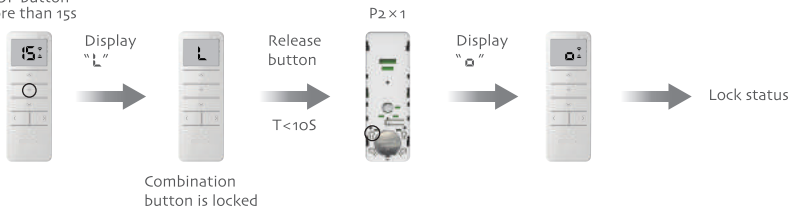

Press and hold STOP button more than 15s

